

# CONFERENCES & EVENTS

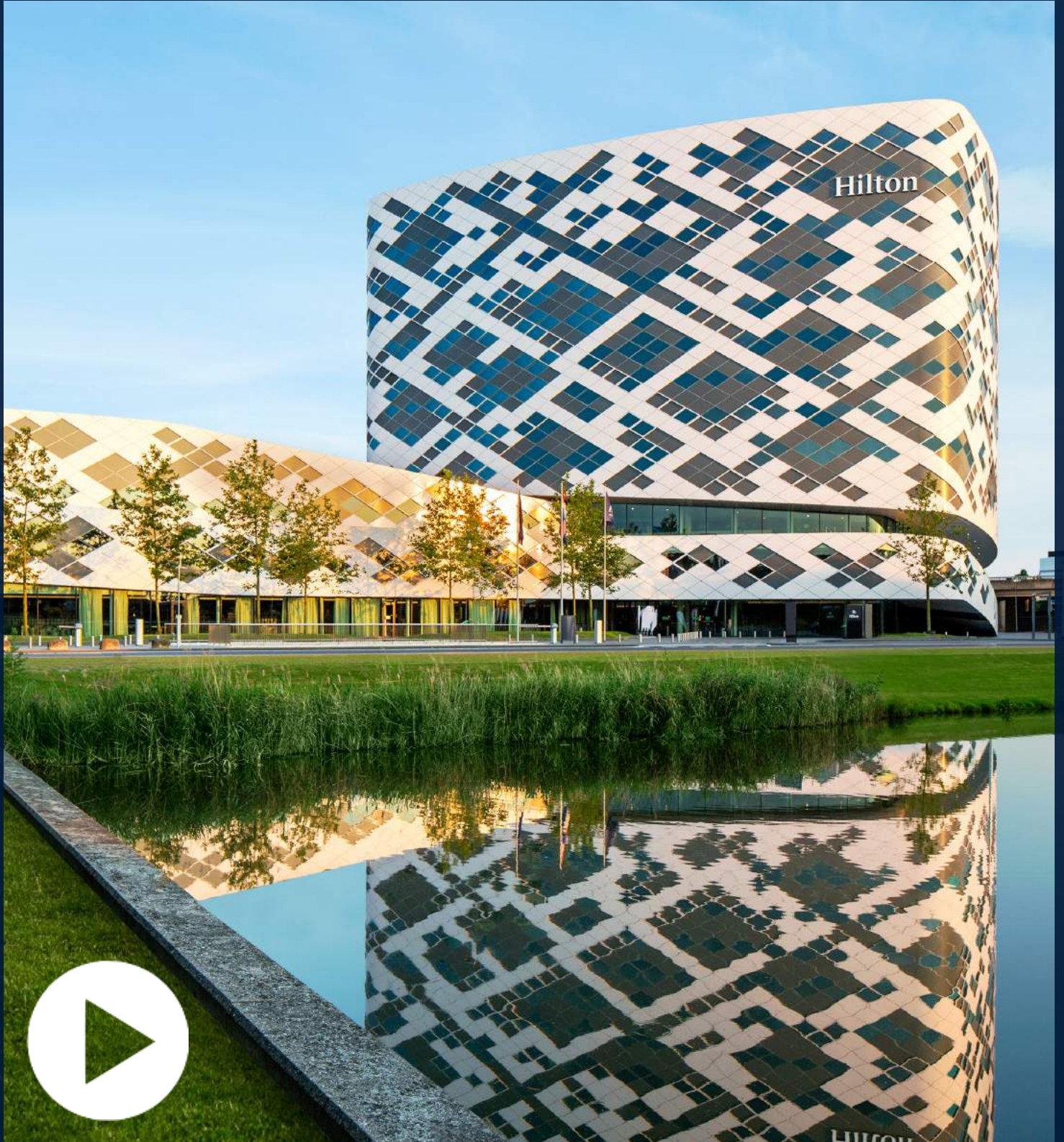

**Hilton**

AMSTERDAM AIRPORT SCHIPHOL

### EAT MEET SLEEP = 350

The hotel can host up to 350 guests to eat, meet and sleep.



**Hotel of the Year Awards**  
Hilton Amsterdam Airport Schiphol has been recognized as the Best Airport Hotel Worldwide 2018 by the Hotel of the Year Awards.



**Travel & Hospitality Awards 2017**  
The hotel received the Travel & Hospitality Award in the category 'Design Hotel of the Year' thanks to the contemporary interior design and stylish decor.



**International Hotel Awards 2017**  
The hotel has been awarded with the International Hotel Award in the categories 'Best Airport Hotel the Netherlands' and 'Best Large Hotel the Netherlands'.

## AT A GLANCE

### MEETINGS

- 1.970m<sup>2</sup> of flexible meeting space
- 26 flexible meeting rooms
- Pillarless ballroom for up to 640 delegates
- Business Centre services
- Dedicated support team
- Build-in AV equipment

### GUESTROOMS

- Total number of rooms: 433
- Standard rooms: 95 rooms
- Deluxe rooms: 196 rooms
- Executive rooms: 130 rooms
- Suites: 12 rooms

### HOTEL SERVICES

- Directly connected to Amsterdam Airport Schiphol
- Direct train connections
- Executive Lounge
- Complimentary Wi-Fi throughout the hotel
- 138-space underground parking garage

### IN-ROOM AMENITIES

- Air conditioning
- Working desk with ergonomic desk chair
- HD television with HD channels
- Mini bar
- Safe
- Iron & ironing board
- Complimentary Wi-Fi in the room

### DINING

- Bowery Restaurant with Asian & grill specialties
- Axis Lobby & Cocktail Bar
- 24-hour in-room dining

### ON-SITE LEISURE FACILITIES

- 24-hour Fitness Centre
- Spa

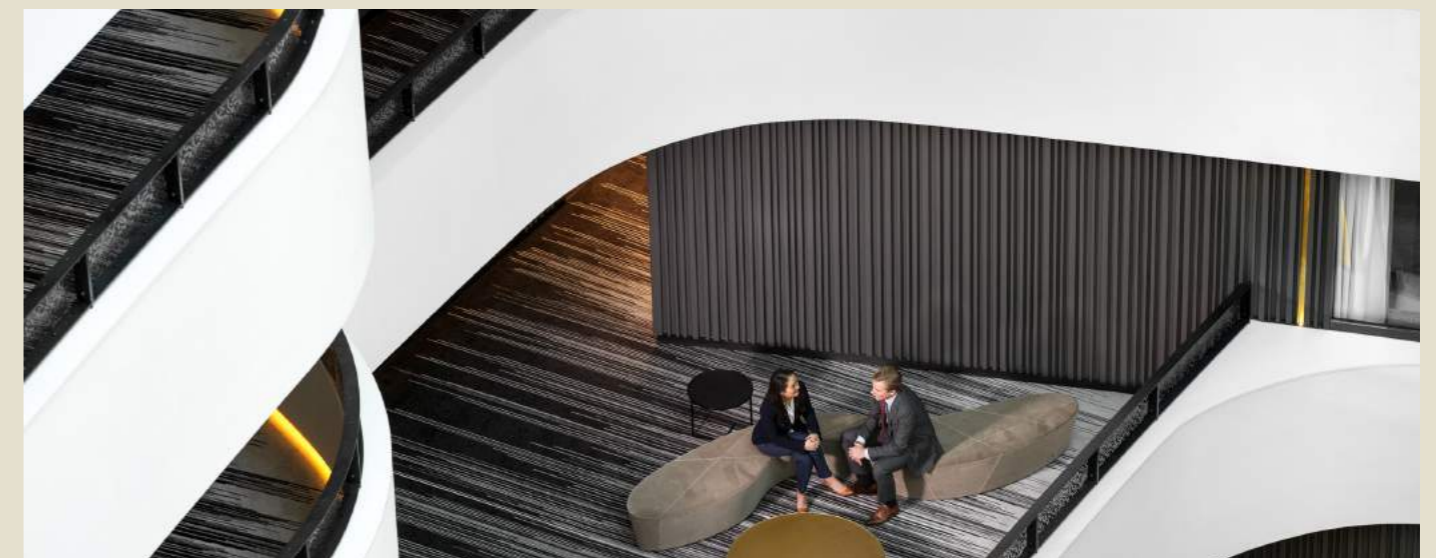

## LOCATION

Directly connected to one of the largest airports in Europe, Hilton Amsterdam Airport Schiphol is easily accessible. Amsterdam city centre is only a 15 minute train ride away.

Via a covered walkway, Hilton Amsterdam Airport Schiphol is directly connected to the airport terminal of Amsterdam Airport Schiphol. The airport terminal directly links guests to over 320 global destinations. Amsterdam Airport Schiphol, Europe's preferred airport, is a hub for both European and international flights, with a variety of airlines flying in and out on a daily basis.

Hilton Amsterdam Airport Schiphol is not only an ideal base for your events, meetings, and short stays but also for guests visiting the cosmopolitan city of Amsterdam.

Schiphol Plaza, the mall located at the airport terminal, is only 7 minutes away by a covered walkway, and offers a wide array of shops and dining options.

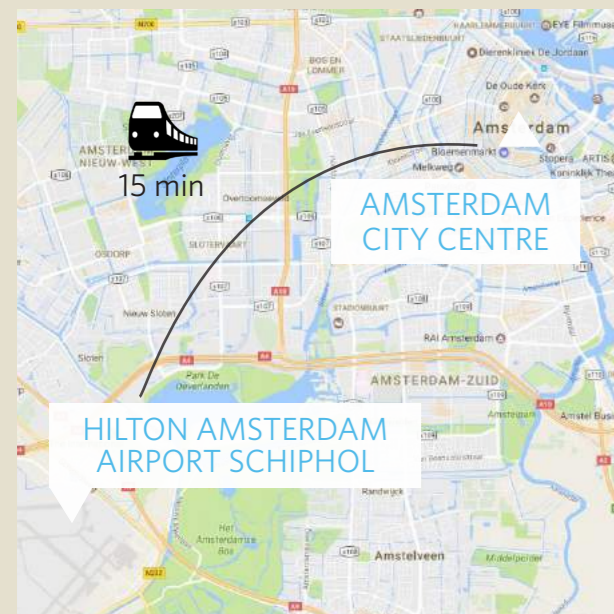

## AMSTERDAM CITY CENTRE

Cobbled streets, canals, historical monuments, the Dam Square, and various shops are just a 15 minute train ride away.

Take a boat tour of the city's meandering canals and waterways, allowing you to see many historical buildings and tourist hotspots in a short time. For more flexibility, choose a hop-on, hop-off 'canal bus,' which lets you disembark at attractions including the Rijksmuseum and the Hermitage Amsterdam.

Enjoy Rembrandt's work at the Rijksmuseum, or visit the striking Stedelijk Museum, which houses contemporary works by artists including Picasso, Matisse and Warhol. Take an emotive trip back in time at the Anne Frank Museum, or admire the vivid floral displays at Keukenhof Parc (open in April & May). Tour the historic former brewery at The Heineken Experience, or simply relax in a canalside café.

# THE HOTEL

**CLICK  
A PART OF  
THE HOTEL**

for more information  
and specifications

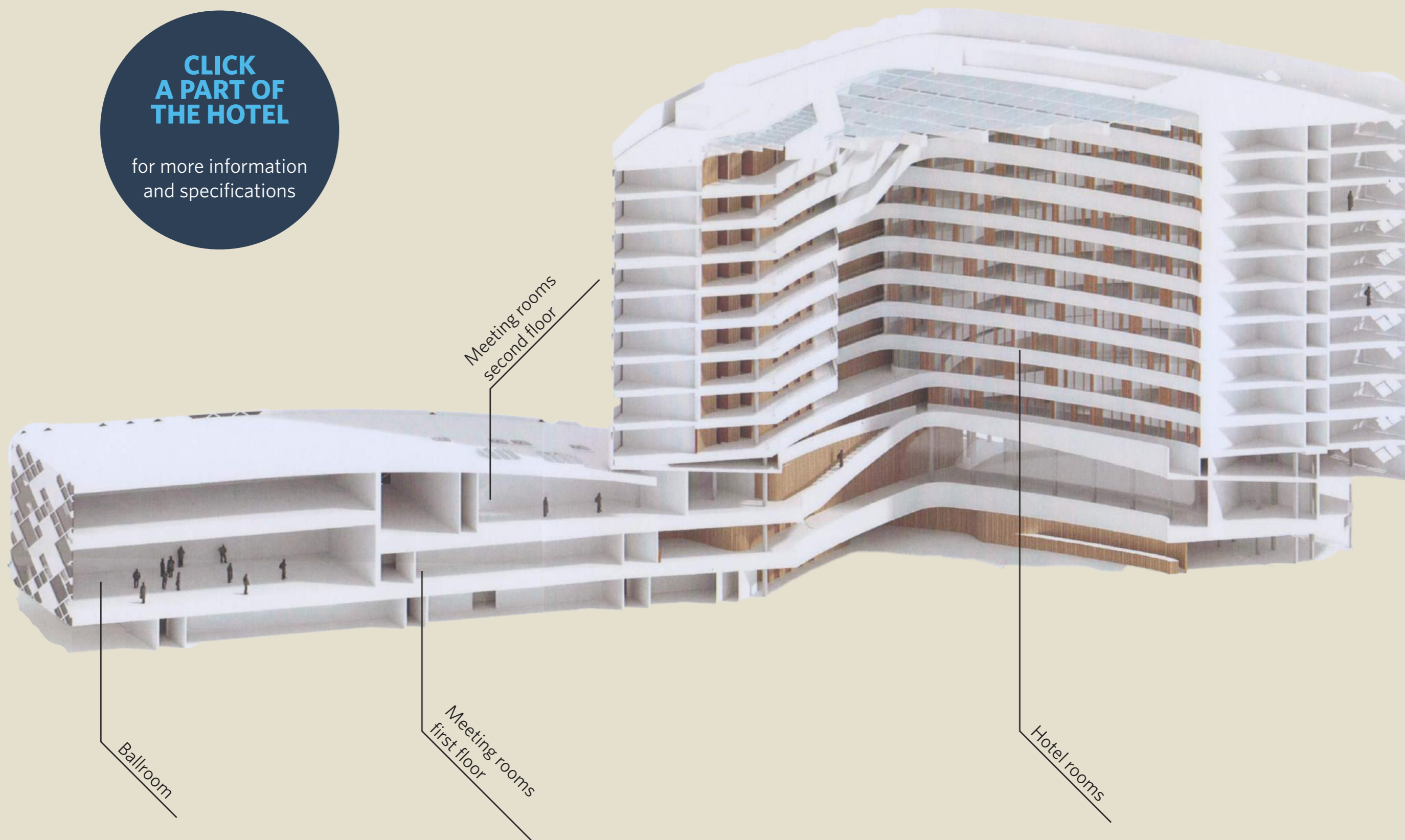

# FLOORPLAN 1<sup>ST</sup> FLOOR

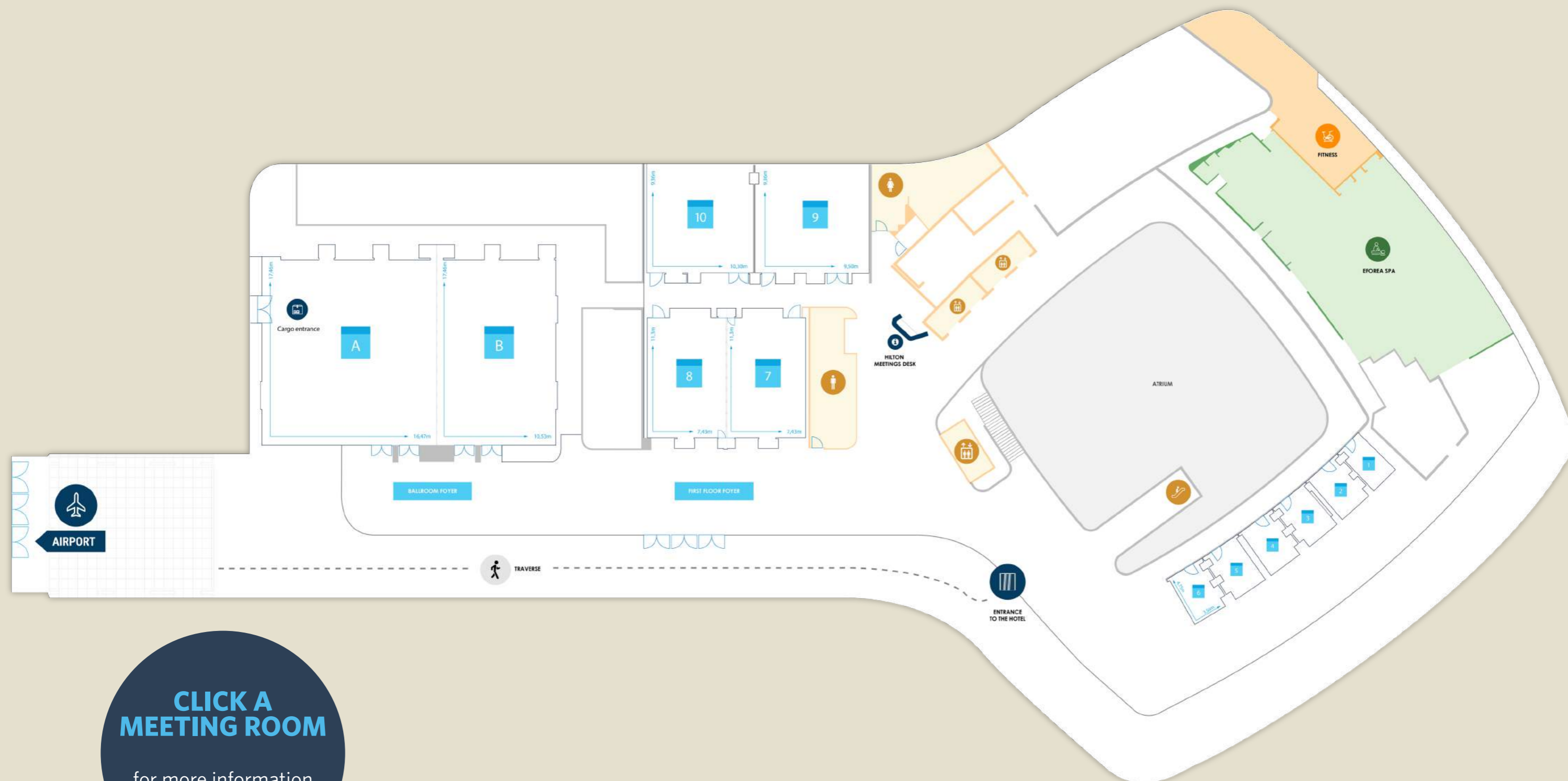

**CLICK A MEETING ROOM**  
for more information and specifications

# FLOORPLAN 2<sup>ND</sup> FLOOR



**CLICK A MEETING ROOM**  
for more information and specifications

# BALLROOM & FOYERS

1<sup>ST</sup> FLOOR

[Back to overview](#)



## ENJOY THE INFINITE POSSIBILITIES OF A 474M<sup>2</sup> VENUE

Our grand pillarless ballroom, located on the 1<sup>st</sup> floor, has space for up to 640 delegates and offers endless opportunities with a 5.65m high ceiling. With the sliding wall the ballroom can be split into two separate areas. With a special cargo entrance the ballroom fits every occasion, from car launches, to large dinners and product launches. In front of the ballroom you will find two foyers: the ballroom foyer and the 1<sup>st</sup> Floor foyer.

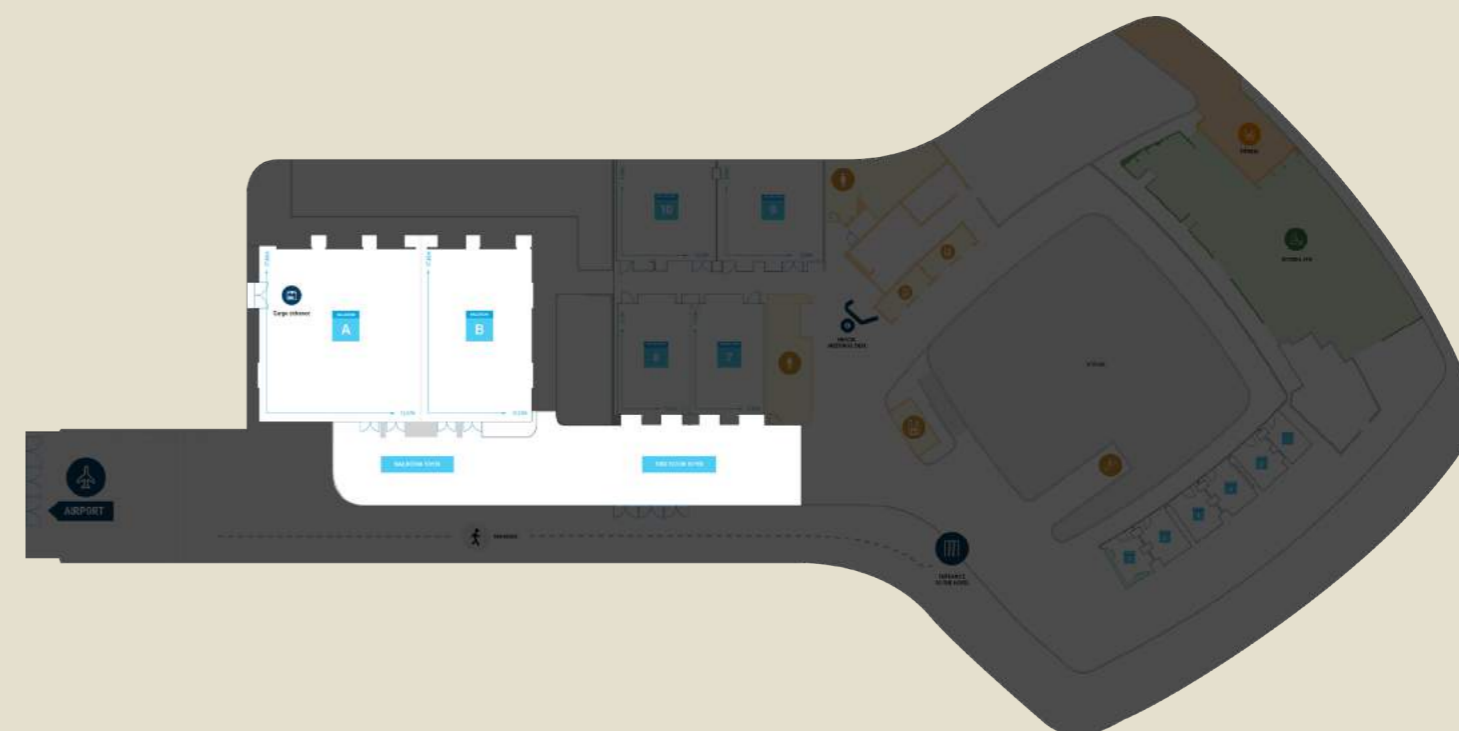
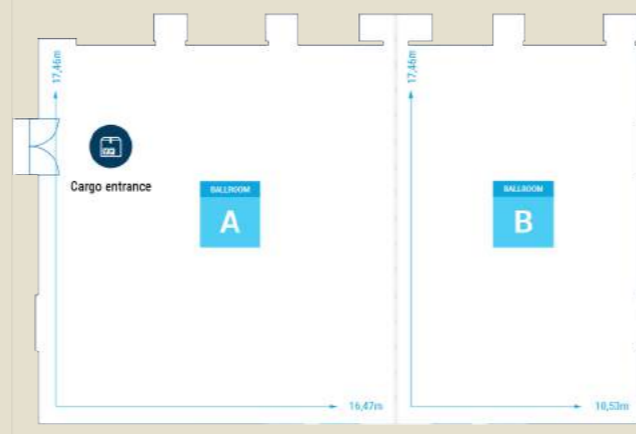

|                             | Boardroom | U-Shape | Theatre | Classroom | Cabaret | Banquet | Reception | Size in m <sup>2</sup> | Dimensions L x W x H (m) | Natural Daylight |
|-----------------------------|-----------|---------|---------|-----------|---------|---------|-----------|------------------------|--------------------------|------------------|
| Ballroom                    | -         | 80      | 640     | 180       | 288     | 360     | 700       | 475                    | 27.7 x 17.1 x 5.65       | no               |
| Ballroom section A          | -         | 54      | 350     | 120       | 144     | 170     | 350       | 281                    | 16.4 x 17.1 x 5.65       | no               |
| Ballroom section B          | -         | 36      | 200     | 60        | 80      | 120     | 250       | 192                    | 11.2 x 17.1 x 5.65       | no               |
| Ballroom foyer              | -         | -       | -       | -         | -       | -       | 145       | 111                    | 18 x 6.2 x 3             | yes              |
| 1 <sup>st</sup> Floor foyer | -         | -       | -       | -         | -       | -       | 165       | 224                    | 29.9 x 7.5 x 3           | yes              |

# MEETING ROOMS

1<sup>ST</sup> FLOOR

[Back to overview](#)



FLEXIBLE MEETING ROOMS ON THE 1<sup>ST</sup> FLOOR AVAILABLE SEPERATELY OR COMBINE 7 AND 8 FOR LARGER GROUPS

Enjoy attentive service from the Hilton Meetings Desk, and boardrooms boasting state-of-the-art audiovisual equipment. Host a creative or less formal Meeting with our living room set-up.

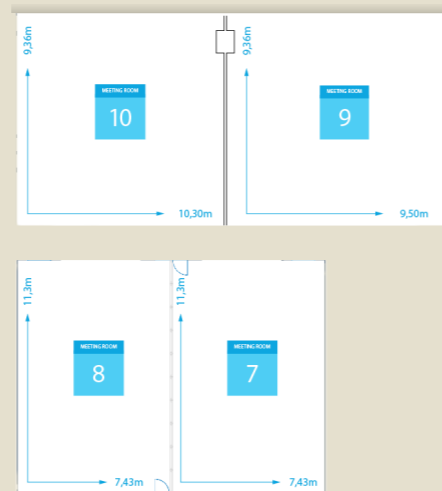

|                     | Boardroom | U-Shape | Theatre | Classroom | Cabaret | Banquet | Reception | Size in m <sup>2</sup> | Dimensions L x W x H (m) | Natural Daylight |
|---------------------|-----------|---------|---------|-----------|---------|---------|-----------|------------------------|--------------------------|------------------|
| Meeting rooms 7, 8  | 24        | 27      | 80      | 36        | 40      | 50      | 91        | 84                     | 11.3 x 7.4 x 3           | no               |
| Meeting rooms 9, 10 | 24        | 27      | 80      | 48        | 48      | 50      | 95        | 96                     | 9.7 x 9.9 x 3            | yes              |
| Meeting rooms 7 + 8 | 36        | 45      | 180     | 72        | 96      | 120     | 185       | 168                    | 11.3 x 14.8 x 3          | no               |

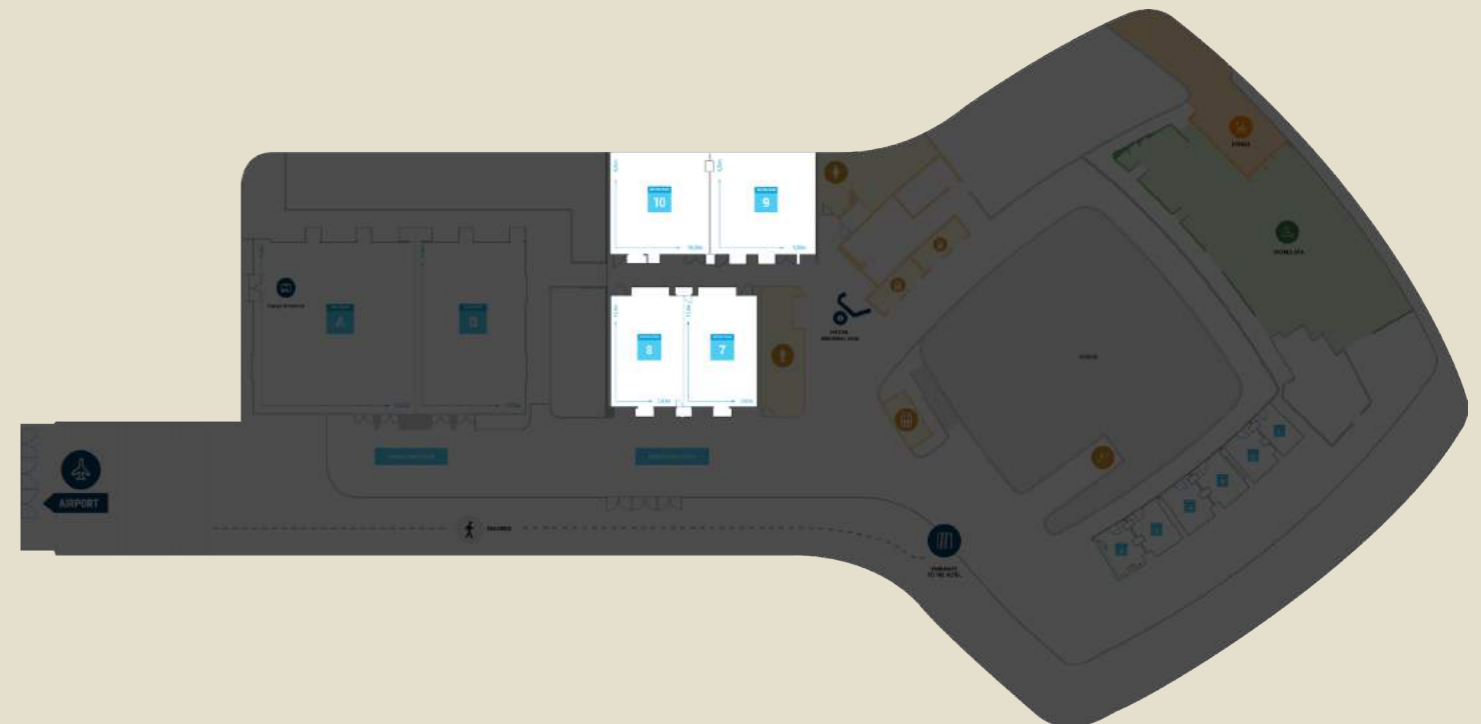



# BOARDROOMS

1<sup>ST</sup> FLOOR

[Back to overview](#)

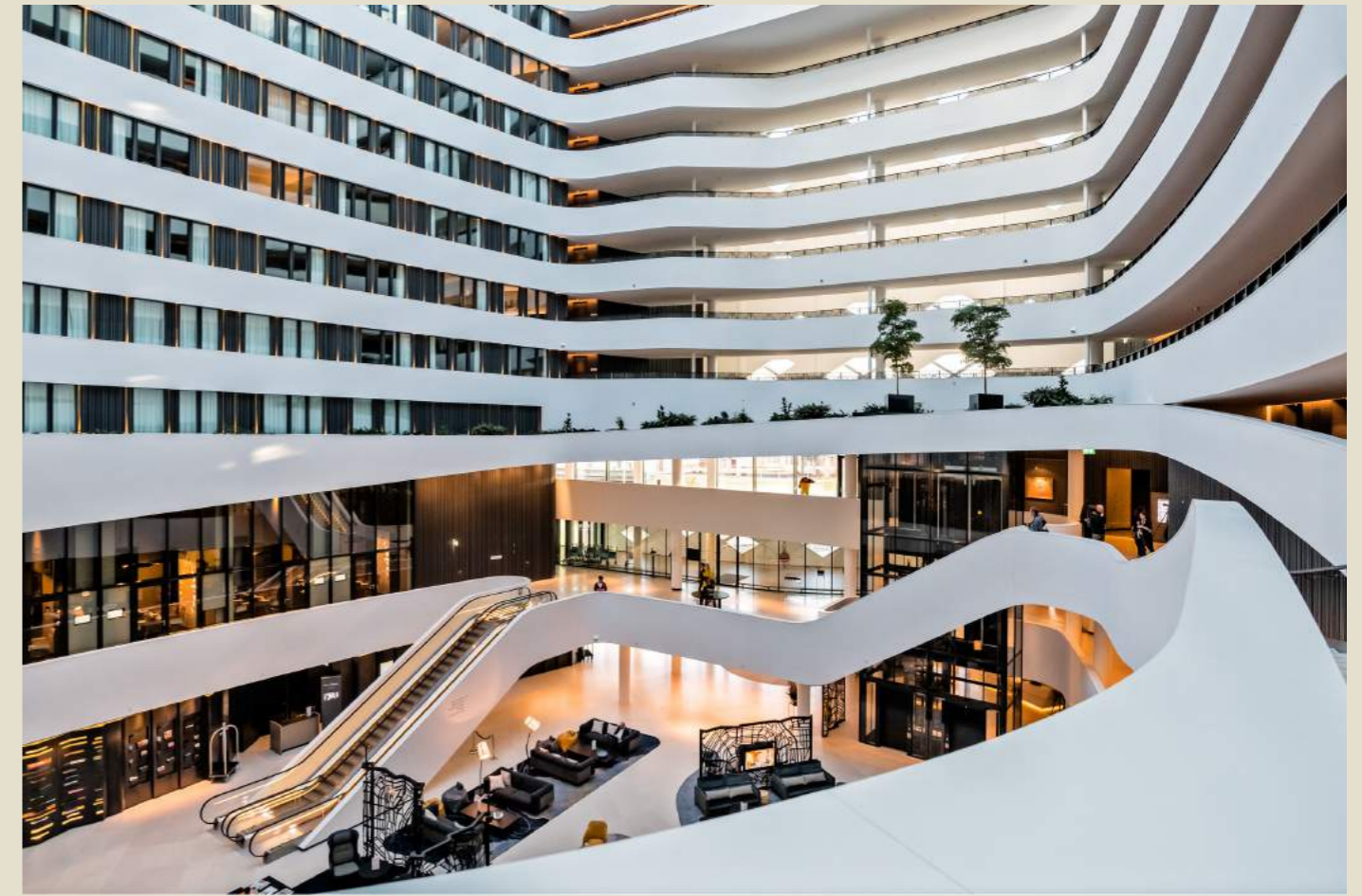

SIX PRIVATE BOARDROOMS, EQUIPPED WITH ERGONOMIC CHAIRS AND THE LATEST AV EQUIPMENT

Enjoy the natural daylight which flows through the 42-meter high glass-roofed atrium. Each boardroom features coffee and tea facilities to ensure a comfortable, hassle-free meeting.

|                      | Boardroom | U-Shape | Theatre | Classroom | Cabaret | Banquet | Reception | Size in m <sup>2</sup> | Dimensions L x W x H (m) | Natural Daylight |
|----------------------|-----------|---------|---------|-----------|---------|---------|-----------|------------------------|--------------------------|------------------|
| Boardroom 1          | 3         | -       | -       | -         | -       | -       | -         | 13                     | 4.8 x 2.7 x 4.5          | yes              |
| Boardroom 2, 3, 4, 5 | 6         | -       | -       | -         | -       | -       | -         | 16                     | 4.8 x 3.3 x 4.5          | yes              |
| Boardroom 6          | 6         | -       | -       | -         | -       | -       | -         | 17                     | 4.8 x 3.5 x 4.5          | yes              |

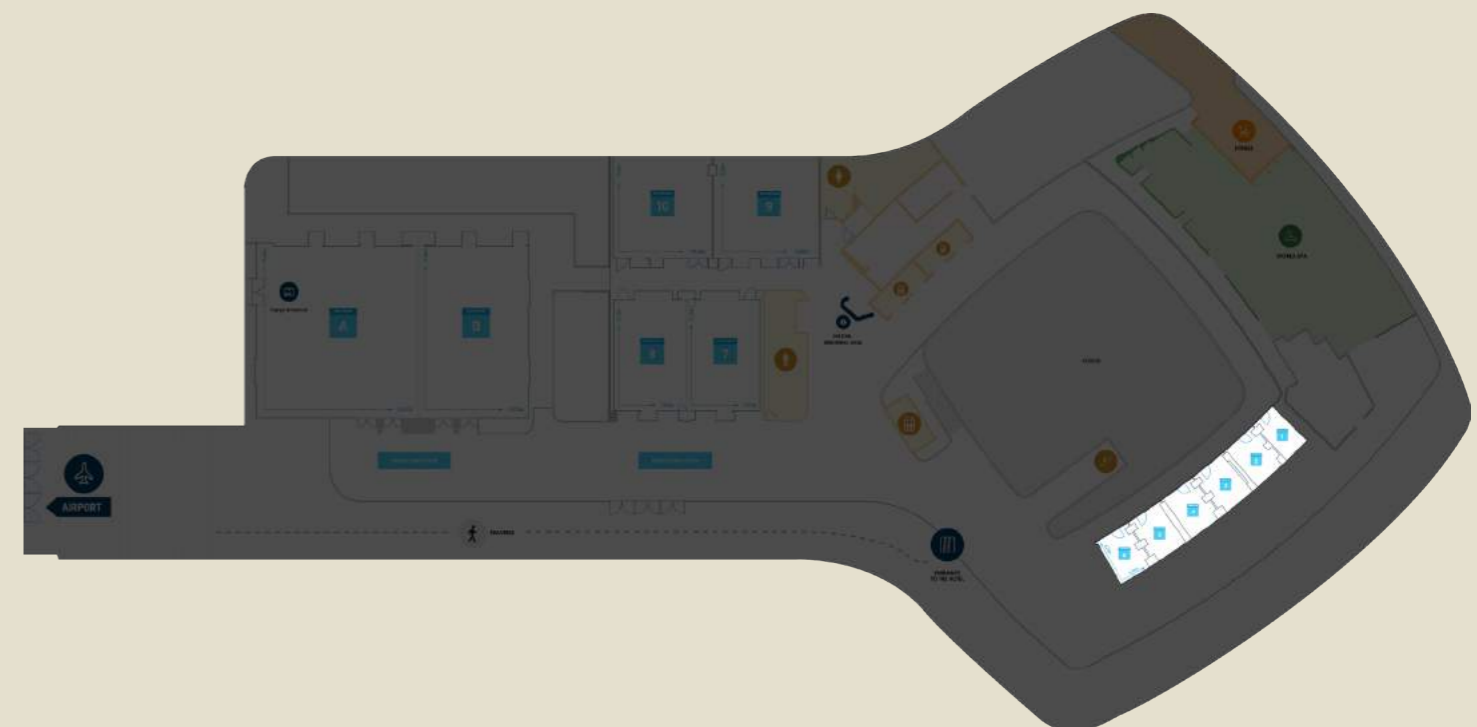

# MEETING ROOMS

2<sup>ND</sup> FLOOR

[Back to overview](#)



## DIVERSE FUNCTION ROOMS LOCATED ON A DEDICATED MEETING FLOOR

The meeting rooms located on the 2<sup>nd</sup> Floor range from 24m<sup>2</sup> to 72m<sup>2</sup>. Each meeting room is equipped with state-of-the-art audiovisual equipment.

The Hilton Meetings Desk will ensure that you and your delegates are looked after.

Keep your energy flowing and be more productive with our meeting room where you can stand at the table.

Enjoy fun, interactive activities during your meeting breaks and challenge your colleagues to a game of table football or play a game of Mario Kart or Donkey Kong with your colleague.



|                                | Boardroom | U-Shape | Theatre | Classroom | Cabaret | Banquet | Reception | Size in m <sup>2</sup> | Dimensions L x W x H (m) | Natural Daylight |
|--------------------------------|-----------|---------|---------|-----------|---------|---------|-----------|------------------------|--------------------------|------------------|
| Atrium foyer                   | -         | -       | -       | -         | -       | -       | 80        | 97                     | 21.1 x 4.6 x 3.5         | yes              |
| Meeting room 11                | 11        | -       | -       | -         | -       | -       | -         | 33                     | 6.6 x 4.9 x 2.6          | yes              |
| Meeting rooms 12, 14, 15, 16   | 16        | 15      | 24      | 12        | 16      | 20      | 35        | 36                     | 7.1 x 5.1 x 3            | yes              |
| Meeting room 17                | 12        | -       | -       | -         | -       | -       | -         | 24                     | 4.1 x 5.8 x 3            | no               |
| Meeting rooms 18, 19, 20, 21   | 12        | 9       | 15      | 12        | 8       | 10      | 35        | 30                     | 5.6 x 5.4 x 3            | no               |
| Meeting rooms 22, 23, 24, 25   | 12        | 15      | 24      | 12        | 16      | 20      | 30        | 31                     | 6.8 x 4.7 x 3            | yes              |
| Meeting rooms 12 + 14, 15 + 16 | 24        | 27      | 50      | 39        | 40      | 50      | 70        | 72                     | 10.2 x 7.1 x 3           | yes              |
| Meeting rooms 18 + 20, 19 + 21 | 24        | 26      | 50      | 30        | 32      | 40      | 70        | 61                     | 11.2 x 5.4 x 3           | no               |
| Meeting rooms 24 + 25          | 22        | 21      | 50      | 36        | 32      | 40      | 65        | 65                     | 6.8 x 9.6 x 3            | yes              |
| Meeting room 26                | 36        | 37      | 100     | 60        | 80      | 100     |           | 160                    | 21 x 7.6                 | yes              |

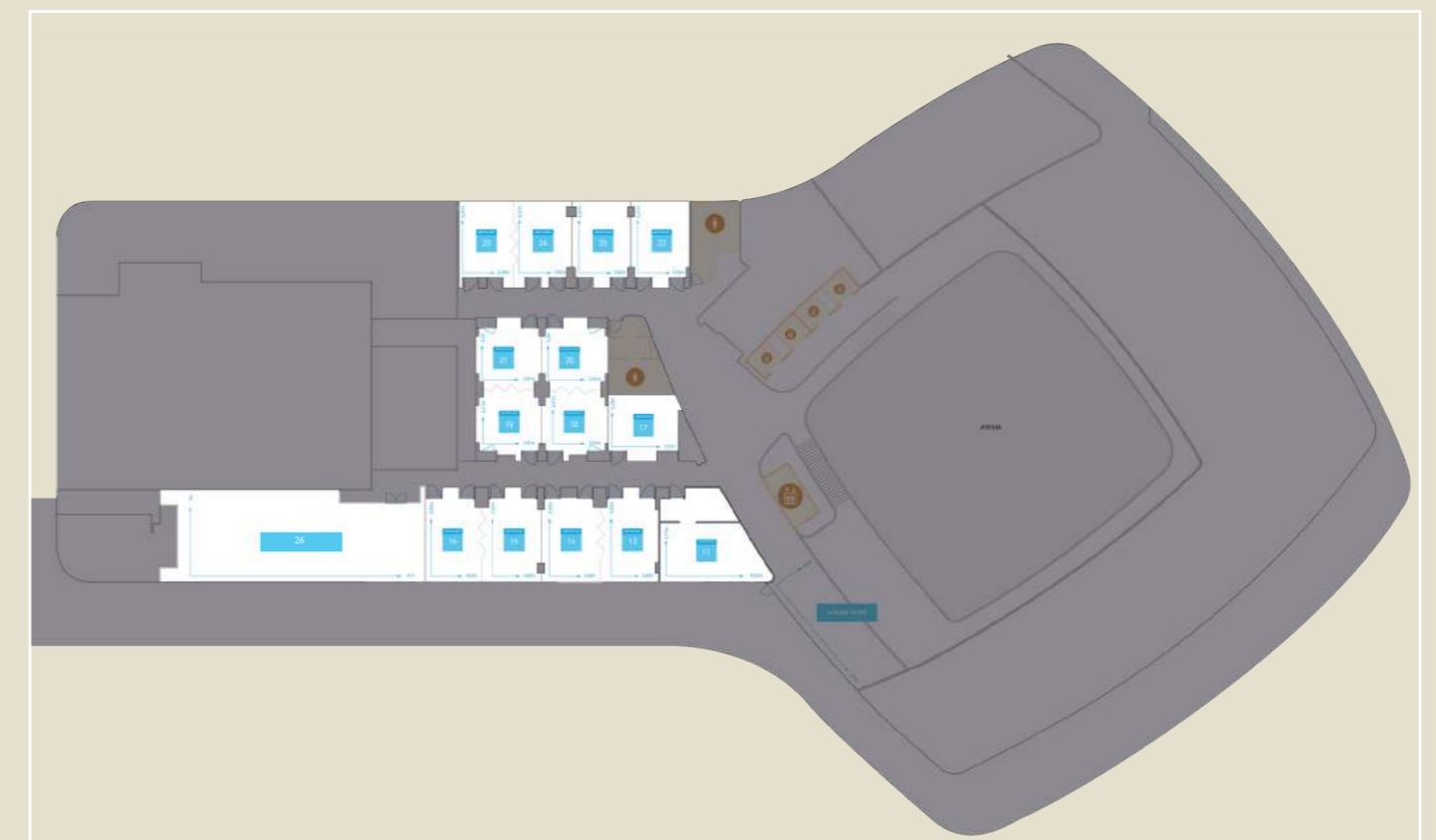



### GUEST ROOM ATRIUM VIEW

Life can be demanding, so take a moment to stop and breathe. Your 27 sq. m. Hilton Guest Room is a welcoming haven of warm colors and contemporary Dutch design. Curl up on the sofa and look out to the 11 story Atrium, dappled by daylight from the impressive skylight - perfect for watching the world come and go.

### JUNIOR SUITE

Space is key in this Junior Suite, with a separate living room to maximize your comfort. Curl up on the sofa and watch a movie or ponder the world through your window, looking over the impressive 11 storey Atrium and stunning skylight. Playful designs, warm golden hues and amenities such as Wifi and tea and coffee making facilities will help you reflect and relax.



### DELUXE ROOM AIRPORT VIEW

Take a moment to soak up the sweeping runway view through diamond-shaped floor-to-ceiling windows in this deluxe 28 sq.m. Guest Room. A fusion of calming colors and cutting edge Dutch design will ignite your senses as you unwind from the outside world. Make the most of the spacious room with amenities such as a 40-inch HDTV and coffee and tea making facilities.

### ONE BEDROOM SUITE

From these high-floored rooms, prepare to be inspired by soaring views of the runway through the floor-to-ceiling diamond-shaped windows. Playful designs, calming hues and Wifi, two HDTVs and tea and coffee making facilities will help you reflect and relax.



### EXECUTIVE ROOM AIRPORT VIEW

Find inspiration from the playful designs in this 27 sq. m. Executive Room featuring access to the exclusive 10<sup>th</sup> Floor Executive Lounge. The lounge offers complimentary breakfast and snacks throughout the day to guests staying on the 9<sup>th</sup>, 10<sup>th</sup> and 11<sup>th</sup> floors. Get to work at the desk using free Wifi or watch a show on the 40-inch HDTV while enjoying a treat from the minibar.

### DIAMOND SUITE

Feel on top of the world in this 11<sup>th</sup> Floor suite, with three separate rooms for sleeping, eating and relaxing, as well as possibilities to connect with the room adjacent. Find yourself inspired by soaring views of the runway through floor-to-ceiling diamond-shaped windows. A fusion of calming colours and cutting-edge Dutch design will ignite the senses.



## MEET WITH PURPOSE

The Meet With Purpose concept makes it easy for professionals to achieve business and sustainability goals in everyday meetings. This concept focusses on the wellbeing of your delegates to ensure you have a successful and productive meeting that has a big impact on your organizational objectives, but a smaller one on the environment.



### MINDFUL MEETING

All about the environment: We endeavor to offer conferences that preserve resources and reduce waste.



### MINDFUL EATING

All about food: Our food and beverage options seek to avoid and reduce food waste, encourage more balanced choices, and offer locally sourced cuisine and seasonal ingredients to support our local communities.



### MINDFUL BEING

All about the delegate: We strive to promote well-being for our guests by adding fitness events, spa promotions, outdoor activities, and breaks that help clients and delegates get the most out of their meetings with us.



## MEETINGS SIMPLIFIED

### SIMPLE PRICING FOR SEAMLESS MEETINGS

Organizing a meeting for up to 25 guests? Meetings Simplified brings easy booking to life. With these six advantages your meeting is booked before you know it. Our hotel has the facilities and services ideally suited for your groups and offer simple, bundled pricing. To begin planning your next meeting, get in contact with our Groups, Conference & Events Team via: [events.amsterdamairport@hilton.com](mailto:events.amsterdamairport@hilton.com) or +31 (0)20 710 4011.

1

#### EASY BOOKING

Your booking is confirmed by pressing one button only

2

#### NO CONTRACT

For booking Meeting Simplified no contract is needed

3

#### FLEXIBLE TERMS

Free cancelation to 24 hours before the meeting

4

#### ADD-ONS

Simply select your own Food & Beverage options

5

#### FREE Wi-Fi

Complimentary wireless internet throughout the hotel

6

#### AV INCLUDED

A LCD projector and screen is always included

# INTERACTIVE ACTIVITIES



Make your event even more special with out-of-the-box experiences. Looking for some fresh air after your meetings? Choose for our beach experiences including blokarting, power-kiting and bubble soccer.

Choose a city experience for some Dutch culture: navigate your own boat with the Amsterdam Boat Rally or do the Guided City Game. Would you rather stay in the hotel for some shorter activities to re-energize for the next part of your meeting?

**Try out the fun Wall Game with different team challenges or have an Escape Room 2.0 experience!**



## CITY EXPERIENCES

### **The Amsterdam Walking Rally**

Visit the Amsterdam highlights while doing different team (building) challenges in the city, testing the skills of every member in your team.

### **The Amsterdam Boat Rally**

Navigate your own boat! Visit all Amsterdam highlights and solve different team challenges throughout the city.

### **Guided City Game**

Sightseeing 2.0: visit the highlights of Amsterdam using an app. Test your knowledge and learn all about Amsterdam during this city game.

## BEACH EXPERIENCES

### **Blokarting**

Try out this adventurous and challenging sport and race together on one of the most beautiful beaches of the Netherlands.

### **Power-Kiting**

Power-Kiting is the latest variant of kiting where you, together with an instructor, learn all about kiting. Are you going sky high or do you manage to stay on the ground?

### **Bubble-Soccer**

Bubble-Soccer is the most spectacular version of soccer. Form teams and find out who's the best in playing Bubble-Soccer!

## INDOOR EXPERIENCES

### **The Wall**

The dinner game of the year! Before every course of your dinner we will 'serve' you different team challenges in every possible theme (movies, news, sports, food & drinks and more).

### **Who's the Meathead**

Can you taste the origin of a wine? How many calories are in one candy bar? Test the culinary knowledge of your team with this fun game.

### **Out of the Box**

Out of the Box is a mobile version of the popular escape rooms. Is your team able to crack all the puzzles (different themes in each box) and solve the mystery of Dr. Erhard?

## BOWERY RESTAURANT



### BOWERY RESTAURANT

The name 'Bowery' derives from the Dutch word 'bouwerij' (farm) as well as an area and street in Lower Manhattan, New York. It represents a perfect link between Dutch legacy and a cosmopolitan approach.

Bowery is an interactive dining experience, where you can create your own dishes and where dishes are prepared à la minute and plated in front of you. This visually inspiring restaurant with open kitchens provides authentic yet contemporary flavours, tasty grill dishes and Asian specialties as well as carefully selected authentic delicacies. Dishes are prepared with local produce from Dutch suppliers and farmers.

Transform your meeting with a unique dining experience at the Bowery restaurant!

Give your delegates a great way to taste the menu with live stations, live cooking story telling and much more.



## AXIS LOBBY & COCKTAIL BAR



### AXIS LOBBY & COCKTAIL BAR

Located in the breathtaking 42-metre-high glass roof atrium, Axis is the heart of the hotel. Axis serves as a bustling café during the day and a lively bar in the evening. Be surprised by the bar's wide selection of Gin and Dutch Jenever. Axis is a true hot spot at the airport, perfect if you want to enjoy a delicious coffee, exciting cocktails or if you are looking for a quick traditional Dutch bite that will keep your hunger at bay.

Complimentary Wi-Fi is available. Stay connected with your family and friends, focus on your work in the relaxing lounge areas, and get inspired by the vibrant atmosphere of Axis.



## 24-HOUR FITNESS CENTRE



### 24-HOUR FITNESS CENTRE

Stay fit while staying in the spacious 24-hour Fitness Centre. Featuring the latest generation of cardio and strength training equipment, Hilton Fitness takes a personalized approach to help you feel your best during your stay. Open 24 hours, seven days a week.

### EFOREA SPA

Feel renewed, uplifted and refreshed at eforea spa. Located on the 1st Floor you can escape from everyday worries and the frantic pace of modern life.

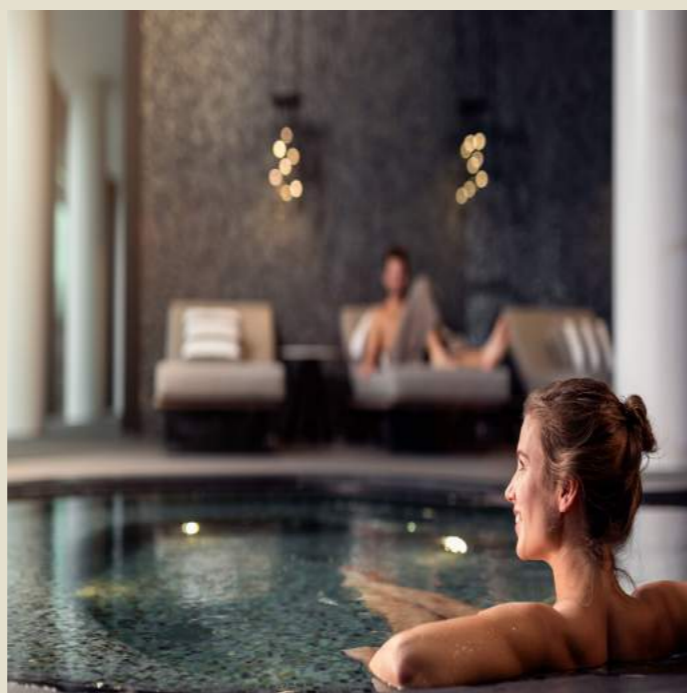

## HILTON SERVICE APP

### REVOLUTIONISING THE EASE OF GETTING INSTANT SUPPORT

The Hilton Service App enables you to get instant support from the Hilton Meetings desk. Whether you're in need of more notepads, or if you need technical assistance, the Hilton Service app features instant messaging,

easy order for miscellaneous items or food and beverage items, and quick overviews of your previous orders and the queue.

[Free download available in the Apple App Store and Google Play Store >](#)

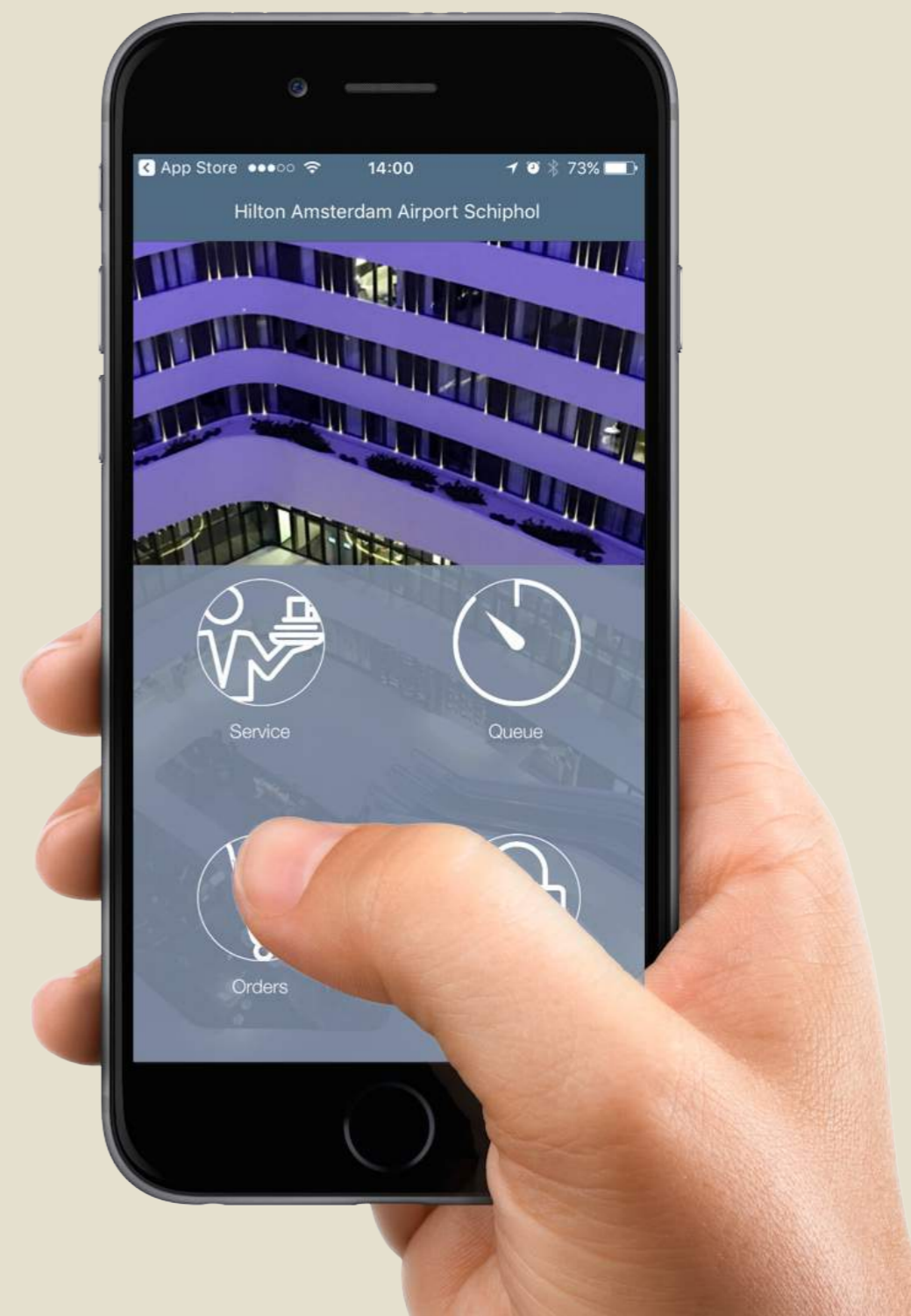



[amsterdamairportschiphol.hilton.com](https://amsterdamairportschiphol.hilton.com)



HILTON AMSTERDAM AIRPORT SCHIPHOL  
Schiphol Boulevard 701 | 1118 BN Schiphol  
T: +31 (0) 20 710 4011  
[events.amsterdamaairport@hilton.com](mailto:events.amsterdamaairport@hilton.com)